

LW Receptacle Assemblies

Features

- Provides secure engagement in thin or soft materials
- Spring-loaded for assisted pin removal
- Provides dust / weather seal

Material

- Stainless steel

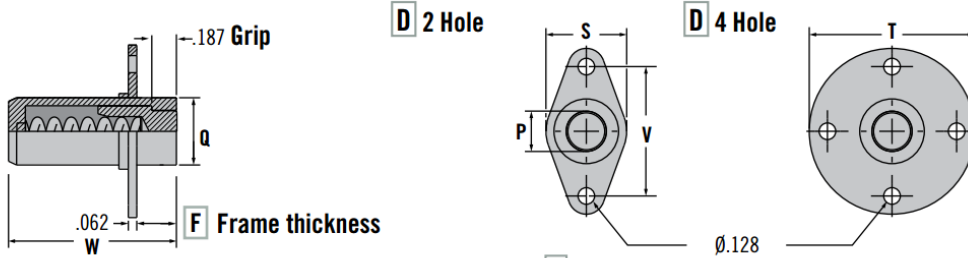

LW - 1981 - **D** C **B** - **F**

- B** Base
- 1 2 hole
 - 2 4 hole

F Frame thickness - in thousands of an inch
(.032 to .500 inch standard, example inch 048 = .048 inch)

Nominal Receptacle Inside Diameter	D Size	Dimensions					
		$\phi P + .001 - .000$	$\phi Q + .001 - .004$	S	ϕT	V	W
3/16	3	.190	.375	.625	1.281	1.000	1.25
1/4	4	.250	.375	.625	1.281	1.000	1.25
5/16	5	.312	.500	.625	1.281	1.000	1.25
3/8	6	.375	.625	.750	1.406	1.125	1.31

QUICK RELEASE PINS

LW Lanyard Assemblies

Material

- Cable: 300 Series stainless steel, vinyl coated
- Tab: Aluminium



Lanyard with tab

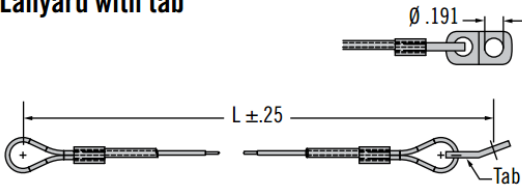

Lanyard no tab

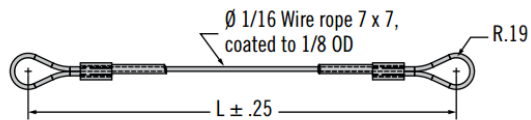

LW - 10 **S** - **F** - **L** - **L**

- S** Style
- 23 With tab
 - 36 No tab

- F** Finish
- 1 Green
 - 2 Red
 - 3 Black
 - 4 Clear
 - 5 Bare

L Length
(Part inches .99 inch max.)

L Length
(Full inches 4 inch min.)



We are proud to be Southco's authorized distributor of over 20 years